

# Tumble dryer

## TD6-45



### Exceptional savings and effortless use



### Priority on people

Certified ergonomic design with a human-centered approach for an outstanding user experience



### Long-term savings

Innovative features to save money and time, and embrace a sustainable lifestyle

- Moisture Balance (optional) helps to stop the drying process at the right time to save on energy costs
- Drum Speed Control adjusts the movement of the drum to help garments move correctly for a faster drying process



### Pure control

Monitor your equipment and performance from anywhere, allowing to take action and to improve your business with OnE Laundry - the personal assistant for hygiene validation management, process management and revenue management (optional)



### Outstanding productivity

Dry 2 loads in one hour  
Reversing drum Minimizes wrinkles and drying time to get an effective and even drying performance



### Global Advanced Hygiene

Global Advanced Hygiene program package<sup>I</sup> with proven log 6 reduction<sup>II</sup> disinfection of textiles through the laundry process, fulfilling the criteria of all local approved standards

I. program is available in the standard library of gas and electric heated dryers, excluding products for specific segments where temperature is not controllable

II. log 6 reduction equals to 99,9999% viral infectivity reduction. The efficacy of reduction of SARS-CoV-2 and other pathogens in the process is confirmed by RISE (The Research Institute of Sweden) on the basis of Electrolux Professional laboratory data



Images shown are a representation of the product only and variations may occur.

## Other options

- Stainless steel front and drum
- Frequency controlled drum motor
- Fresh air intake
- Kits available: Indicator lamp for finished drying cycle, Stop button and External light/sound

Main specifications		TD6-45			
Rated capacity, filling factor 1:20	kg / lb	45 / 100			
Rated capacity, filling factor 1:18	kg / lb	50 / 110			
Drum, volume	litre	900			
Drum, diameter	ø mm	1240			
Heating alternatives:					
Gas	kW / BTU/h	63 / 215 000			
Steam at 700 kPa	kW	60			
EI	kW	48/60			
Consumption data <sup>I</sup>		Gas	Steam	EI	
Total time	Min	31	34	48 kW	60 kW
Energy consumption	kWh	34	32	30	32
Evaporation	g/min	719	663	645	712
Energy kWh/litre water evaporated	kWh/l	1.56	1.47	1.36	1.44

I. At rated capacity 1:20, 100% cotton load at 50% initial moisture dried to 0%.

Produced according to ISO 9001 and ISO 14001.

Certified with CB certificate for Low Voltage Directive and S-mark according to the Machinery Directive. Protection class IP X4D.

Electrical connections					
Heating alternative	Main voltage	Hz	Heating power kW	Total power kW	Recommended fuse A
Electric heated machines	220-230V 3~	50/60	48	50.2	160
	240V 3~	50/60	48	50.2	125
	380-415V 3~	50/60	48/60	50.2/62.2	80/100
	440V 3~	60	48/60	50.2/62.2	80/100
	480V 3~	60	48/60	50.2/62.2	63/80
Gas- and Steam heated machines	220-480V 3~	50/60	<sup>1</sup>	2.2	10

1. Total power and recommended fuse does not depend on the heating power in those cases.

Steam, gas and air connections			TD6-45
Steam	ISO 228/1-G1		1"
Steam pressure	kPa		100-1000
Steam consumption	kg/h		143
Condensate	ISO 228/1-G1		1"
Gas	ISO 7/1-R1		1"
Gas pressure, Natural gas	Pa		2000
	mbar		20
Gas pressure, Propane	Pa		2800-5000
	mbar		28-50
Air outlet	ø mm		315
Evacuated air, steam	m <sup>3</sup> /h		2300
Evacuated air, gas	m <sup>3</sup> /h		2300
Evacuated air, electric	m <sup>3</sup> /h		2300
Pressure drop	Max. Pa		100
Sound levels			
Sound power/pressure level at drying <sup>1</sup>	Hz		20.8
Heat emission			
% of installed power, max	dB(A)		73/58
Shipping data <sup>2</sup>			
Heating unit, gas/steam/electric	net, kg		39/50/42
	total net, kg		545
	crated, kg		69/80/72
	total crated, kg		576
Shipping volume, heating unit	m <sup>3</sup>		0.48
	total m <sup>3</sup>		3.65
1. Heating unit	6. Electric connection		
2. Delivery height, excl. 100 mm packaging	7. Exhaust duct		
3. Operating panel	8. Steam inlet		
4. Door opening, ø 940 mm	9. Steam return		
5. Gas connection			

1. Sound power levels measured according to ISO 60704.

2. Average data. Crated weight/shipping volume depends on configuration. Please contact logistics for exact measures.

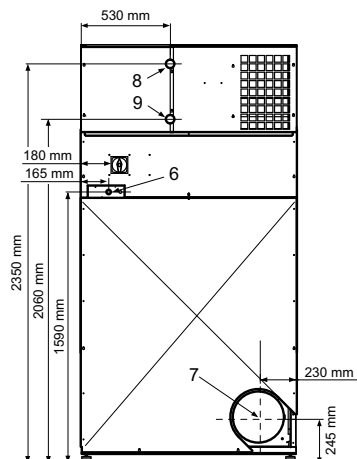
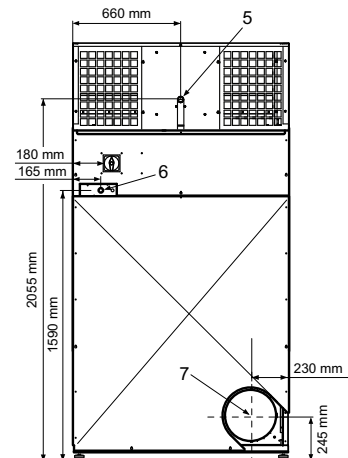
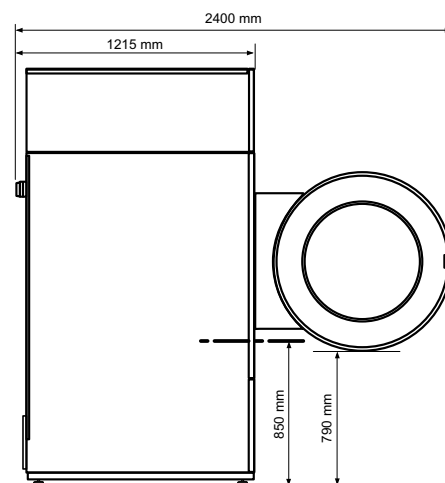
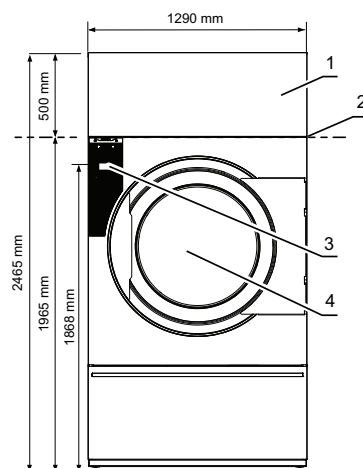

Experience the Excellence  
www.electroluxprofessional.com

438918180EN/2023.01.24  
We reserve the right to alter specifications without notice