

# Drying cabinet

## DC6-14

**Drying Cabinets have no mechanical action and are used to efficiently dry bulky items such as workwear/overalls/gloves and boots or delicate items such as silk and linen**



### Priority on people

Ergonomic design, with user friendly positioning of door handle, control panel and suitable for disabled users

- Easy operation with 2 automatic drying programs, which will stop once the load is dry
- The control panel has Braille for the visually impaired
- Large doors and opening angles for easy access
- One extensible hanger for easy loading/unloading
- Hanging ability in the short end for smaller garments
- Flexible installation with adjustable feet



### Productivity

Time saving when used instead of flat or hang drying. The door can be opened a short moment without stopping the drying process

### Safety

Option to activate child safety start lock



Main specifications		DC6-14
Rated capacity	kg	10
Evaporation*	g/min	95
Drying time cotton*	min	58
Rated input	kW	9
Energy/load of linen	kWh/kg	0.82
Energy/water evaporated	kWh/l	1.49

\* Mixed cotton load centrifuged to 55% residual moisture.

Electrical connection		DC6-14
Voltage		
400V 3N AC 50 Hz	kW(A)	9.1(16)
Connections		
Outlet*	∅ mm	200
Evacuated air quantity*	m <sup>3</sup> /h	400
Pressure drop*	Max. Pa	0*
Sound level		
Pressure level***	dB(A)	<70
Weight		
	net, kg	175**
Dimensions in mm		
A	Width	1805
B	Depth	800
C	Height	1805
D		875
E		1560
F		900
G		1885
H		400
I		850
J		1325



\* Duct fan required

\*\* Applies to assembled drying cabinets

\*\*\* Sound power levels measured according to ISO 60704

Colour of front and side panels is silver grey and handle is dark blue

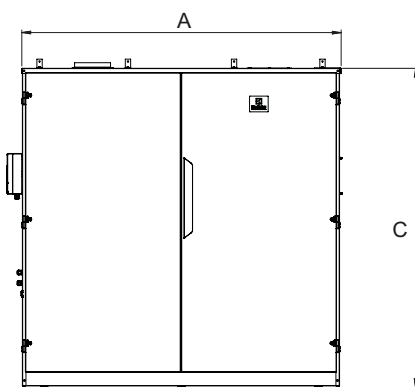

Front

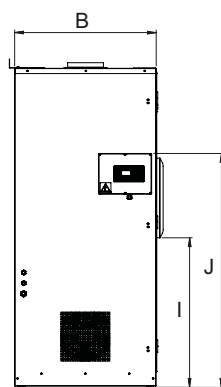

Right side

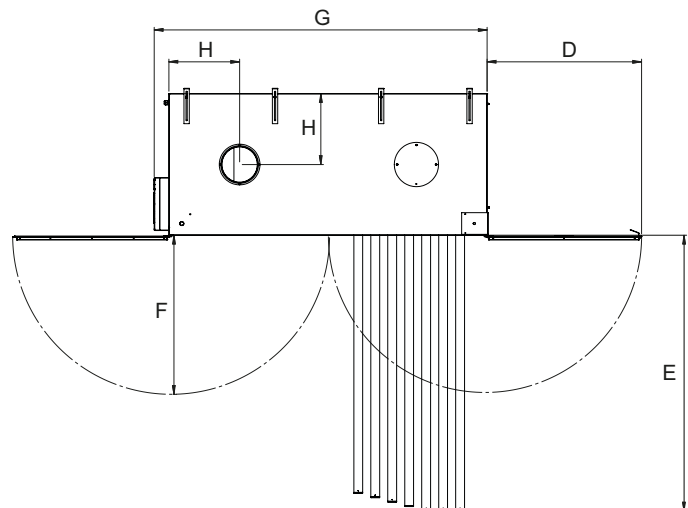

Top view